

 Sandberg®

5
Years
Warranty



Quick Guide

136-72

www.sandberg.world

USB3.2 Cloner Dock for NVMe M.2 SSD

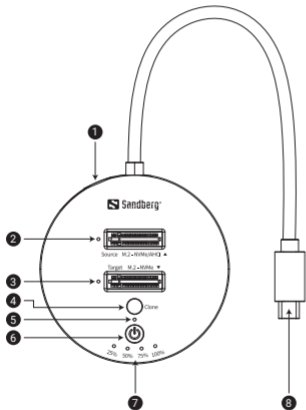
Product overview

1. USB-C 5V DC IN
2. Source:
M.2 NVMe/AHCI slot
SSD indicator
3. Target:
M.2 NVMe slot
SSD indicator
4. Clone button
5. Power indicator
6. Power switch
7. Clone indicator
8. USB-C data transfer port

Connection

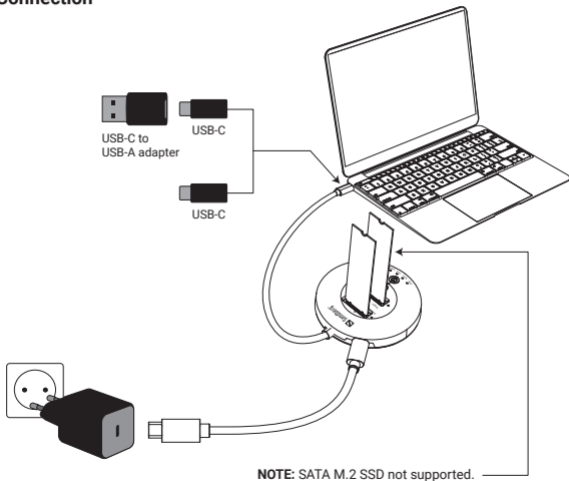

Dock function

Read and write to the disks connected to the dock.

NOTE: Brand new drives must be formatted before use.

NOTE: Only the source slot supports AHCI SSD with AHCI to NVMe adapter.

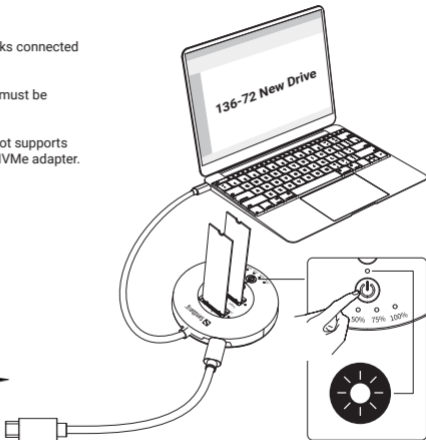
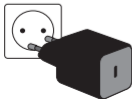

Offline clone

1.

NOTE: Before starting clone process, please make sure that the target disk has bigger capacity than the source disk.

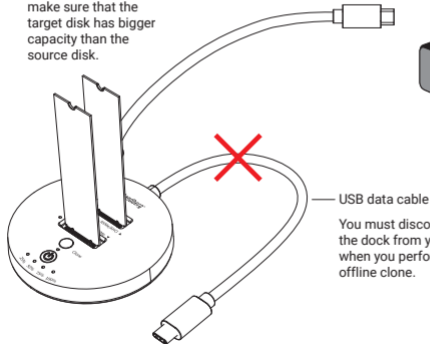

USB data cable

You must disconnect the dock from your PC when you perform an offline clone.

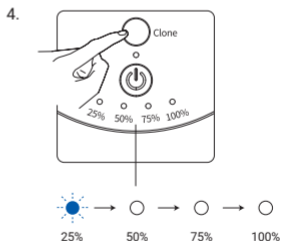
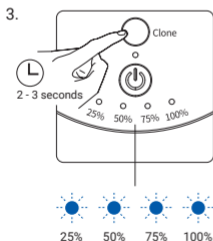
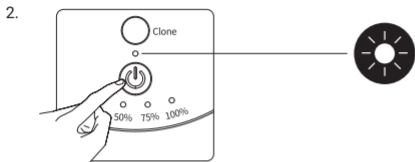

5.

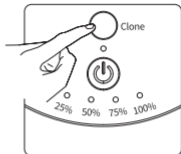
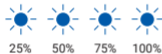
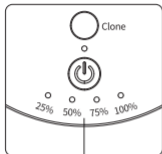

Turn off the power.

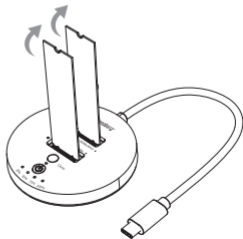

Remove the drives.

Support

<http://helpdesk.sandberg.world>

Warranty

There is a five-year warranty on your Sandberg product. Please read the warranty terms and register your new Sandberg product at www.sandberg.world/warranty

5
Years
Warranty

USB3.2 Cloner Dock for NVMe M.2 SSD Item no. 136-72

www.sandberg.world

info@sandberg.world

Sandberg A/S

Bregnerødvej 133D,

3460 Birkerød, Denmark

Made in China



For information on handling electronic waste, see www.sandberg.world/weee